

MEHC3 series

ELECTRIC GRIPPER (WITH MOTOR)



Selector Table Applications

Features

- Self-locking mechanism prevents loosening, ensuring secure and reliable gripping.
- Compatible with seven types of gripper jaws to meet diverse needs.
- Provides five mounting surfaces for flexible adaptation to various applications.
- Integrated motor and controller offer a space-saving, compact design.
- Operated via I/O signals for quick and straightforward control.
- Three adjustable gripping force levels allow flexibility for different workpieces.

Motor type	Step motor	Transmission	Lead screw
Environment	Standard	Guide type	Linear guide

Specification

Model	MEHC3		
Size	16	25	
Total jaw stroke (mm)	6	14	
Gripping force *1	Level 1 (N)	12	25
	Level 2 (N)	17	33
	Level 3 (N)	22	41
Opening / Closing time (sec)	0.5		
Transmission	Lead screw		
Guide type	Non-recirculating linear bearings		
Repeatability *2 (mm)	±0.02		
Operating temperature (°C)	5 ~ 40		
Operating humidity (%RH)	<85 (Non-condensing, no dew formation)		
Control method	I/O, Built-in controller		
I/O interface	Input	3 points (PNP)	3 points (NPN)
	Output	1 point (NPN)	1 point (NPN)
Rated voltage (V)	DC24 ±10%		
Power consumption *3	Standby (W)	1	1
	Level 1 (W)	3	3
	Level 2 (W)	6	5
	Level 3 (W)	9	7
Weight (kg)	0.3	0.8	

*1. Gripping force tolerance ± 20%.

*2. The offset value of the gripped item under the same gripping parameters.

*3. The power consumption indicated for each gripping force level represents the instantaneous maximum power consumption.

Order example

MEHC3 — 16 — N — 005

Model	Size	I/O+Power cable length
	16 25	005 0.5 m 015 1.5 m (standard)

Jaw type			
Blank: Standard	1: Standard (Side tapped)	2: Standard (Through hole)	3: Flat
N: Narrow	N1: Narrow (Side tapped)	N2: Narrow (Through hole)	

Evaluation of gripping force

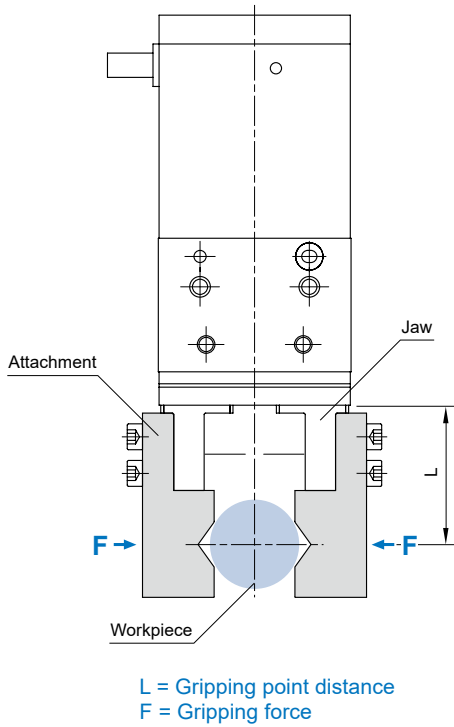

Allowable moment and force (N.m / N)

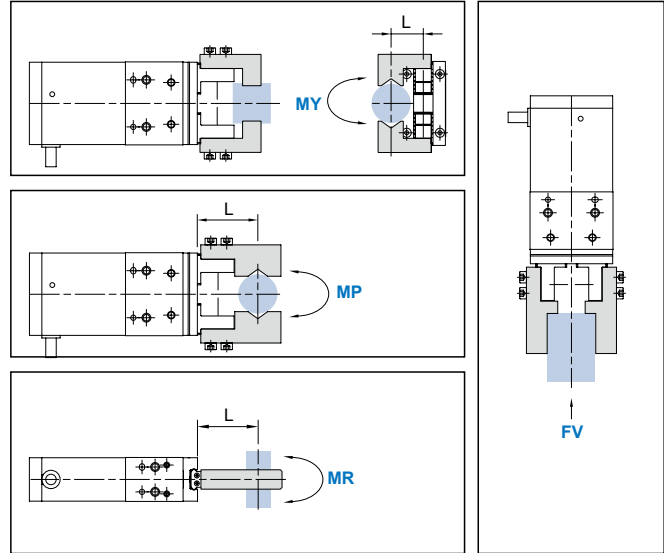

Model	MY	MP	MR	FV
	Max. moment (N.m)			Max. force (N)
MEHC3-16	0.68	0.68	1.36	98
MEHC3-25	1.94	1.94	3.88	255

*1. The force and moment values in the table are static values.
*2. When used for handling, please consider acceleration and deceleration inertia.

Gripping force diagram

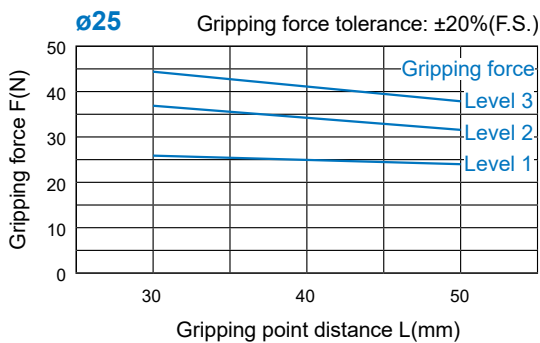
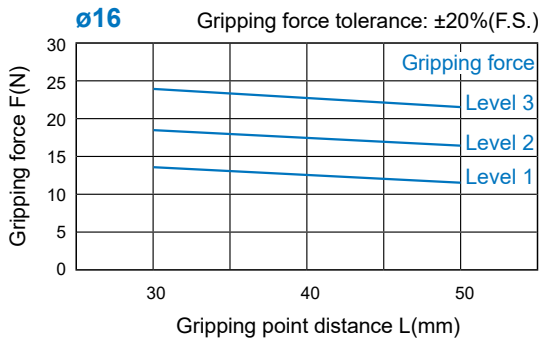

Pin assignment of I/O cable

Size	16		25	
	PIN No.	Function	Color	Function
1	VCC (24VDC)	Red	VCC (24VDC)	Red
2	GND	Black	GND	Black
3	Input 1	Red	Input Com	Red
4	Input 2	Black	Input 1	Black
5	Input 3	Yellow	Input 2	Yellow
6	Input Com-	Black	Input 3	Black
7	Output 1	Red	Output 1	Red
8	Output 1 Com-	Black	Output 1 Com-	Black

Input 3	Input 2	Input 1	Function
Off	Off	On	Close jaws
Off	On	Off	Open jaws
On	Off	Off	Clear alarm

On	Off	On	Set level 1 gripping force
On	On	Off	Set level 2 gripping force
On	On	On	Set level 3 gripping force

Output 1	Gripping force reaches the set value
----------	--------------------------------------

* Please carefully and thoroughly refer to the user manual for the wiring of the I/O cables.

MEHC3 Dimensions 16

ELECTRIC GRIPPER (WITH MOTOR)

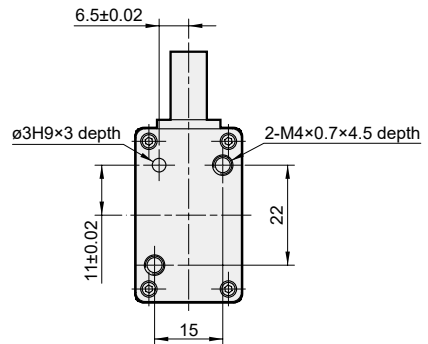
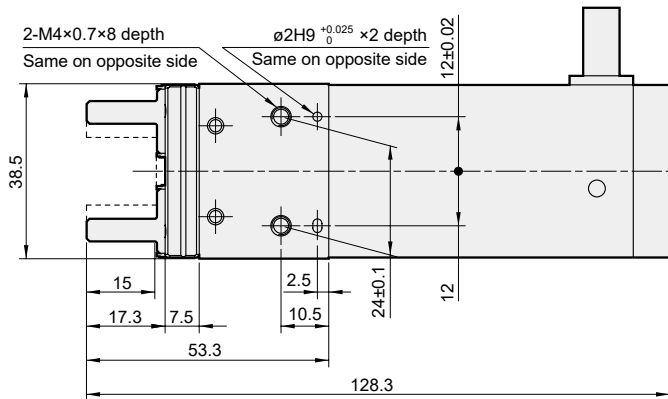
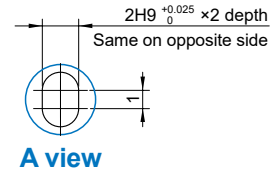
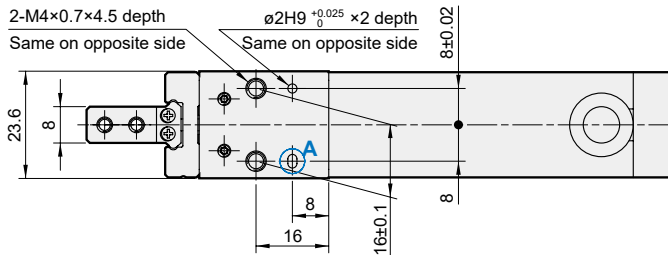

Standard

1: Standard (Side tapped)

2: Standard (Through hole)

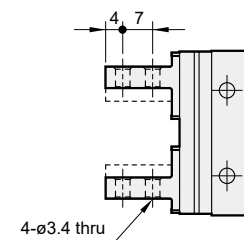
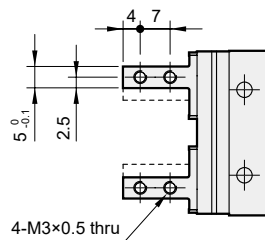
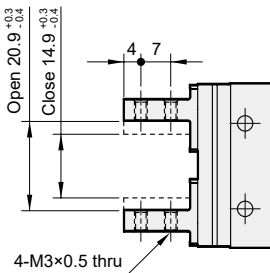

N: Narrow

N1: Narrow (Side tapped)

N2: Narrow (Through hole)

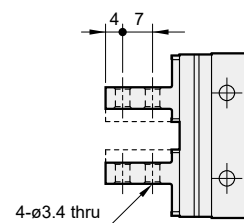
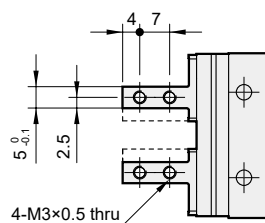
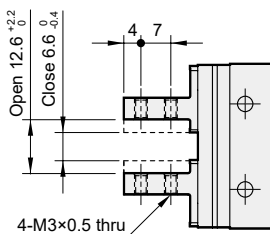

3: Flat

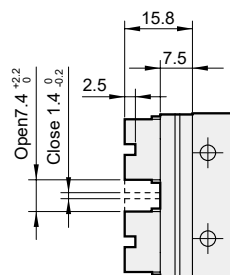
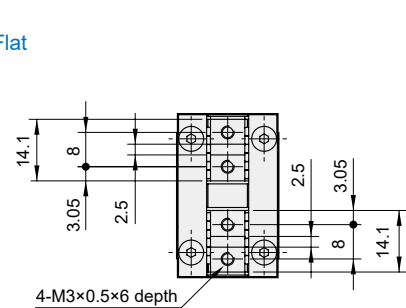

MEHC3 Dimensions 25

ELECTRIC GRIPPER (WITH MOTOR)

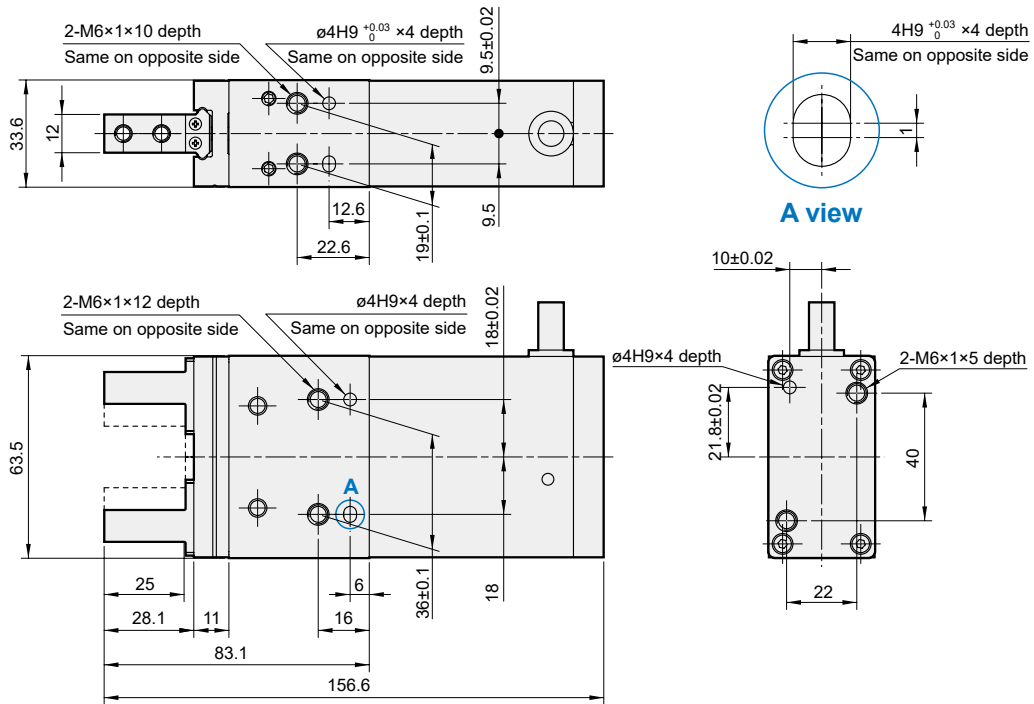

A view

Standard

1: Standard (Side tapped)

2: Standard (Through hole)

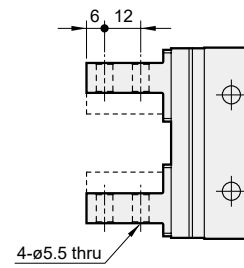
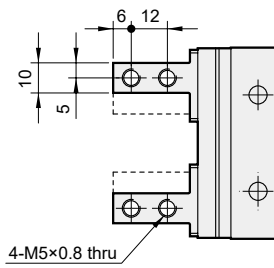
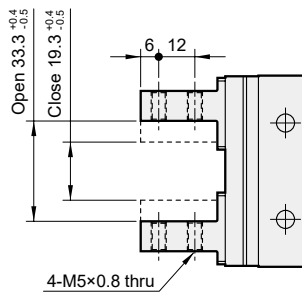

N: Narrow

N1: Narrow (Side tapped)

N2: Narrow (Through hole)

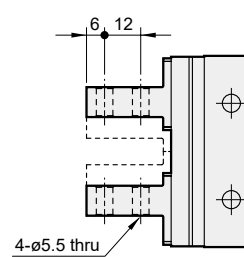
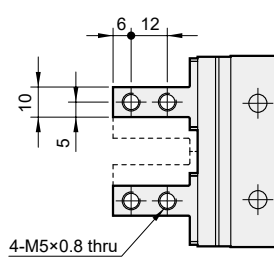
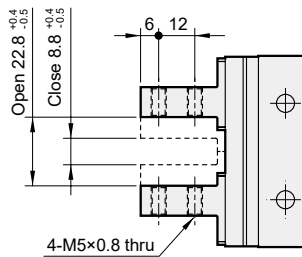

3: Flat

